



SPENCER JAMES
RESIDENTIAL

8 Hartlepool Court | London E16 2RL
T: +44 (0) 20 7474 3636
E: mail@spencer-james.co.uk
www.spencer-james.co.uk



**** Three Double Bedroom Flat ****

**** Modern Bathroom ****

**** Balcony ****

**** Available Now ****

**** EPC Rating C ****

**** Walking Distance to King George DLR ****

**** Council Tax C £1,304 ****



Lynton House, Albert Walk, E16

Monthly Rental Of £1,650



This spacious three bedroom top floor apartment is available to let in April and is situated just moments from King George V DLR station. Comprising of a spacious living area and open plan kitchen with modern appliances, a large balcony, modern bathroom, street parking and Juliet balcony from the main bedroom. Landlord is willing to access DSS tenants with working guarantor T&C apply

room16name}

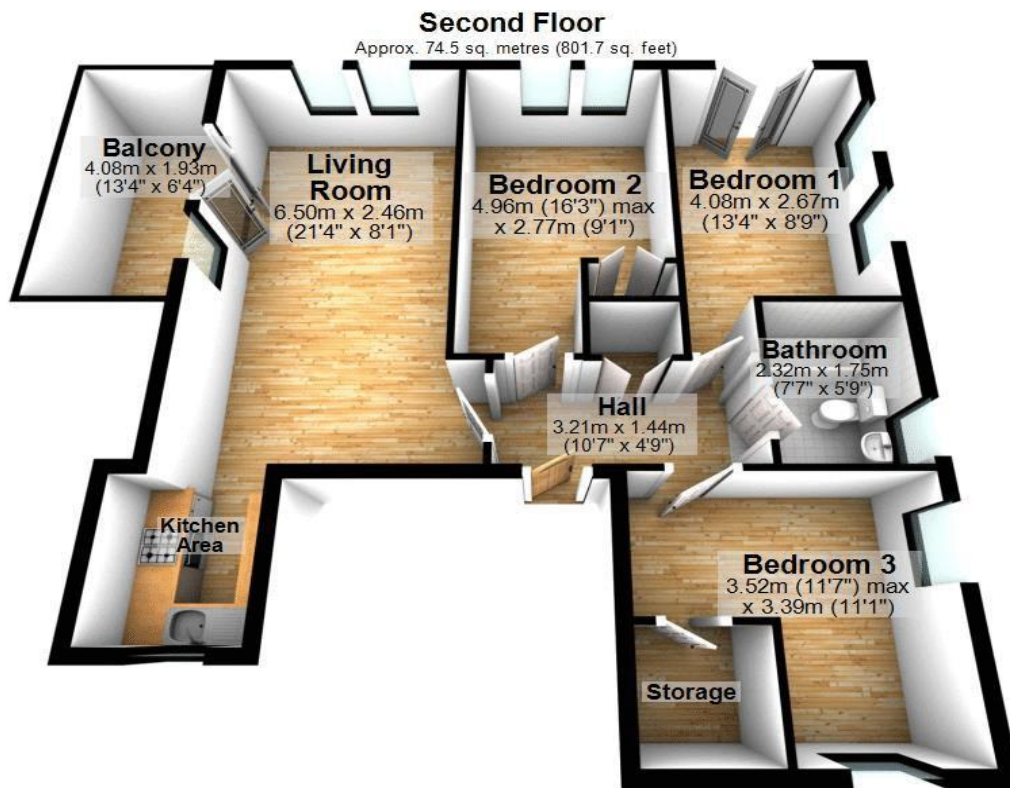

Total area: approx. 74.5 sq. metres (801.7 sq. feet)



SPENCER JAMES
RESIDENTIAL





SPENCER JAMES
RESIDENTIAL

